



# Office of General Services

DESIGN & CONSTRUCTION GROUP  
THE GOVERNOR NELSON A. ROCKEFELLER  
EMPIRE STATE PLAZA  
ALBANY, NY 12242

---

## ADDENDUM NO. 2 TO PROJECT NO. 47028

---

### CONSTRUCTION, ELEVATOR AND ELECTRICAL WORK REHABILITATE ESCALATORS CULTURAL EDUCATION CENTER EMPIRE STATE PLAZA ALBANY, NY

May 2, 2025

**NOTE:** This Addendum forms a part of the Contract Documents. Insert it in the Project Manual. Acknowledge receipt of this Addendum in the space provided on the Bid Form.

#### GENERAL REQUIREMENTS - COMMON

1. SECTION 011000 SUMMARY OF THE WORK, Article 1.11: Add the following Paragraph:
  - “Q. Work Restrictions:
    1. ALL work shall be behind work barriers unless otherwise coordinated with Director's Representative.
    2. No special restrictions to noisy work within work barriers.
    3. All welding will require Hot Work permits and work plan coordinated with Directors Representative.
    4. Material Movement to be coordinated with Directors Rep.”

#### CONSTRUCTION WORK SPECIFICATIONS

2. SECTION 042200 CONCRETE UNIT MASONRY: Discard the Section bound in the Project Manual and substitute with the accompanying Section (pages 042200 – 1 thru 042200 – 6) noted “Addendum 02”.

#### ELEVATOR WORK SPECIFICATIONS

3. SECTION 143100 ESCALATOR MODERNIZATION, Paragraph 1.07, F, 4: Change Paragraph to read:
  - “4. Deliver 3 sets of all portable diagnostic keyboards and/or programming tools required for service or maintenance to the Director’s Representative. Include manuals containing passwords, set-up parameters, fault coding and all other operational and maintenance requirements.”

4. SECTION 143100 ESCALATOR MODERNIZATION, Paragraph 2.03, C, 1: Change Paragraph to read:
  - “1. Drive Machine: A totally enclosed drive system specially designed for this service shall be provided. It shall include a drive motor and electro-magnetic brake. Main and handrail drive chains shall not be required with the direct drive system. The drive machine shall be designed to substantially match speeds of the step band and handrails. Lubrication of the gears and bearings shall be by synthetic based oil bath.”
5. SECTION 143100 ESCALATOR MODERNIZATION, Paragraph 2.03, D, 1: Change Paragraph to read:
  - “1. Step Guidance: A step guidance system shall be provided to control the movement of the steps both horizontally and vertically. Each step shall be provided with horizontal guide pads, or lip tracks, which shall guide the steps throughout their travel, in combination with a continuous guide profile installed in the area of the escalators open to passengers. ASME A17.1 Code Step/Skirt Performance Index requirements shall be met.”
6. SECTION 143100 ESCALATOR MODERNIZATION, Subparagraph 2.03, D, 4, c: Change Subparagraph to read:
  - “c. The rolling surface of the incline track shall be a minimum thickness of 2.5mm.”
7. SECTION 143100 ESCALATOR MODERNIZATION, Paragraph 2.03, F, 1: Change Paragraph to read:
  - “1. Single brush guards shall be provided to protect the step/skirting gap. They shall follow the nose line of the steps, running continuously throughout the length of the moving step band and terminating 2" before the comb plates at both ends. At each end of the brush guard there shall be a smooth tapered aluminum leading piece to ensure that there are no sharp edges, which may be a hazard to passengers. The holder/basis shall be made of clear or black coated aluminum.”
8. SECTION 143100 ESCALATOR MODERNIZATION, Paragraph 2.03, G, 3: Change Paragraph to read:
  - “3. Access Covers: Provide aluminum access covers. The design of these skid resistant access covers shall allow for ease of maintenance. These covers shall be provided at both upper and lower landings.”
9. SECTION 143100 ESCALATOR MODERNIZATION, Subparagraph 2.03, G, 4, a: Change Subparagraph to read:
  - “a. The escalators shall be designed with aluminum access cover extensions and fillers as required to match existing opening dimensions which shall be constructed of the same material as the access covers.”
10. SECTION 143100 ESCALATOR MODERNIZATION, Subparagraph 2.03, G, 5, a: Change Subparagraph to read:
  - “a. Provide aluminum landing plates of similar material used for the access covers. Covers shall be permanently fastening to framing supports.

11. SECTION 143100 ESCALATOR MODERNIZATION, Paragraph 2.03, H: Change Paragraph to read:

“H. Lubrication System Requirements: (Where and as required by Manufacturer)”

12. SECTION 143100 ESCALATOR MODERNIZATION, Paragraph 2.03, I, 3: Change Paragraph to read:

“3. Front-plates: Front-plates shall be provided at upper and lower ends designed to include the handrail inlet device. Material: Metal. Color: Black.”

13. SECTION 143100 ESCALATOR MODERNIZATION, Paragraph 2.03, I, 4: Change Paragraph to read:

“4. Skirts: Provide 11-gauge metal skirt panels as recommended by escalator manufacturer to comply with "Loaded Gap" and "Step Performance Index" code requirements. Finish color to be black unless otherwise approved.”

14. SECTION 143100 ESCALATOR MODERNIZATION, Subparagraph 2.03, L, 8: Delete Subparagraph in its entirety.

15. SECTION 143100 ESCALATOR MODERNIZATION, Paragraph 2.03.O: Delete Paragraph in its entirety.

## **ELECTRICAL WORK SPECIFICATIONS**

16. SECTION 260532 INTERIOR RACEWAYS, FITTINGS, AND ACCESSORIES, Article 2.01: Add the following Paragraph:

“B. Rigid Ferrous Metal Conduit: Steel, hot dipped galvanized on the outside and inside, UL categorized as Rigid Ferrous Metal Conduit (identified on UL Listing Mark as Rigid Metal Conduit – Steel or Rigid Steel Conduit), by Allied Tube & Conduit Corp., Republic Conduit, or Wheatland Tube Co.”

17. SECTION 260532 INTERIOR RACEWAYS, FITTINGS, AND ACCESSORIES, Paragraph 3.02 A: Change Paragraph to read:

“A. Electrical Metallic Tubing: (Areas outside those listed to be Rigid Ferrous Metal Conduit Below)

18. SECTION 260532 INTERIOR RACEWAYS, FITTINGS, AND ACCESSORIES, Article 3.02: Add the following Paragraph:

“B. Rigid Ferrous Metal Conduit:  
1. Shall be installed exposed as branch circuit conduits in Switchboard rooms, Mechanical Equipment Rooms, Machine Rooms, and any area below 10’-0” above Finished floor that is not in an enclosed cavity, i.e., In walls, ceilings, etc.”

**COMMON DRAWINGS**

- 19. Revised Drawing:
  - a. Drawing No. G-101 noted “REVISED DRAWING 4/30/2025” accompanies this Addendum and supersedes the same numbered originally issued drawing.

**CONSTRUCTION WORK DRAWINGS**

- 20. Revised Drawings:
  - a. Drawing Nos. A-102, AD-405, A-405 and A-407, noted “REVISED DRAWING 4/30/2025” accompany this Addenda and supersede the same numbered originally issued drawings.

- 21. A Series Drawings:
  - a. DRAWING NOTES, Change Note 001 to Read:  
  
“PROVIDE CUT STONE PANELS MATCHING SIZE OF REMOVED STONE MODIFIED AS REQUIRED FOR SCHEDULED FIRE SHUTTER TRACK AND AED CABINETS WHERE LOCATED - INSTALL FLUSH TO EXISTING STONE FACE”

- b. DRAWING NOTES, Change Note 020 to Read:  
  
“PROVIDE 24" X 30" NON-FIRE RATED ACCESS DOOR - LOCATE IN COORDINATION WITH REQUIRED DEVICE ACCESS ABOVE CEILING”

- c. DRAWING NOTES, Change Note 041 to Read:  
  
“SOLID GROUT OPEN/EXPOSED MASONRY CORES TO MAINTAIN WALL RATING AND PROVIDE 24" x 30" FIRE RATED ACCESS DOOR”

- 22. AD Series Drawings:
  - a. DRAWING NOTES, Change Note 009 to Read:  
  
“PROVIDE TEMPORARY 18" X 24" SIGNAGE INDICATING "ESCALATOR OUT OF SERVICE, WE APOLOGIZE FOR ANY INCONVENIENCE" - COORDINATE EXACT LOCATION OF SIGNAGE WITH DIRECTOR'S REPRESENTATIVE AND PROVIDE SIGNAGE INDICATING LOCATION OF ELEVATORS / ESCALATORS AND EXITS AVAILABLE FOR PUBLIC USE

- 23. Drawing No. AD-406:
  - a. DETAIL 5/AD-406: Change Drawing Note “D01” located on the left side of the detail, pointing to the small dashed line box area opposite of Drawing Note D04, to read "D11".

**ELEVATOR WORK DRAWINGS**

- 24. Revised Drawings:
  - a. Drawing Nos. U-102 and U-405 noted “REVISED DRAWING 4/30/2025” accompany this Addendum and supersede the same numbered originally issued drawings.

**ELECTRICAL WORK DRAWINGS**

25. Drawing No. E-001:

a. GENERAL NOTES, Add the following Note:

“16. CONCURRENT WORK IS BEING PROVIDED UNDER SEPARATE ALLOWANCES RELATED TO THESE DOCUMENTS SCOPE OF WORK FOR FIRE ALARM AND EMERGENCY COMMUNICATIONS. WORK SHALL BE COORDINATED BETWEEN EACH TRADES WORK.

A. HONEYWELL (FIRE ALARM VENDOR) SHALL PROVIDE ALL DEVICES, PROGRAMMING, AND TESTING. THE ELECTRICAL CONTRACTOR SHALL PROVIDE INFRASTRUCTURE FOR FIRE ALARM SCOPE INCLUDING ALL RACEWAYS, CONDUIT, WIRING, BACKBOXES, DEVICE INSTALLATION, AND FINAL CONNECTIONS.

B. ALARM & SUPPRESSION (EMERGENCY COMMUNICATIONS VENDOR) SHALL PROVIDE ALL DEVICES, PROGRAMMING, DEVICE INSTALLATION AND TESTING. THE ELECTRICAL CONTRACTOR SHALL PROVIDE INFRASTRUCTURE FOR EMERGENCY COMMUNICATION SCOPE INCLUDING ALL RACEWAYS, CONDUIT, WIRING, BACKBOXES, FINAL CONNECTION OF DEVICE AND INSTALLATION OF MODIFIED AED CABINETS.”

26. Drawing No. E-401:

a. GENERAL NOTES, Note 3: Delete in its entirety.

27. Drawing No. E-402:

a. GENERAL NOTES, Note 3: Delete in its entirety.

28. Drawing No. E-403:

a. GENERAL NOTES, Note 4: Delete in its entirety.

29. Drawing No. E-404:

a. GENERAL NOTES, Note 3: Delete in its entirety.

**END OF ADDENDUM**

Brady M. Sherlock, P.E.  
Director, Division of Design  
Design & Construction

**SECTION 042200****CONCRETE UNIT MASONRY****PART 1 GENERAL****1.01 RELATED WORK SPECIFIED ELSEWHERE**

- A. Mortar and Grout: Section 040513.

**1.02 SUBMITTALS**

- A. Product Data: Catalog sheets, specifications, and installation instructions for the following:
  - 1. Masonry wall reinforcement.
  - 2. Buck anchors.
- B. Quality Control Submittals:
  - 1. Test Reports: Certified test reports for concrete masonry units showing that materials for delivery to the Project meet the requirements of these Specifications.

**1.03 QUALITY ASSURANCE**

- A. The Contractor agrees, that if the value of this contract exceeds \$100,000 all structural steel, reinforcing steel and other major steel items to be incorporated in the Work of this Contract shall be produced and made in whole or substantial part in the United States, its territories or possessions.

**1.05 DELIVERY, STORAGE, AND HANDLING**

- A. Store masonry units off the ground on platforms that allow air circulation under stacked units.
- B. Cover and protect masonry units against wetting prior to use.
- C. Handle masonry units on pallets or flat bed barrows.

**1.06 PROJECT CONDITIONS**

- A. Environmental Requirements; Cold Weather Conditions:
  - 1. Do not use frozen materials or materials coated with ice or frost.
  - 2. Materials stored outside or in otherwise unheated spaces are to be moved to the work area 24-hours prior to installation.

**PART 2 PRODUCTS****2.01 CONCRETE MASONRY UNITS**

- A. Hollow Non-Load-Bearing Units: ASTM C 129, Type I.
- B. Fire Rated Units: Aggregate type and equivalent solid thickness as required to obtain the fire resistance rating indicated. Ratings shall be based on fire tests in accordance with ASTM E 119.
- C. Aggregate:
  - 1. Lightweight Units: ASTM C 331; dry net weight not more than 105 lb per cu ft.
  - 2. Normal Weight Units: ASTM C 33; dry net weight not less than 125 lb per cu ft.
- I. Special Shapes: Units of shape and size required for lintels, corners, jambs, sash, control joints, headers, bonding, and other special conditions indicated.
  - 1. Outside Corners: Square edge units, unless otherwise shown.
  - 2. Units for Walls and Partitions to be Vertically Reinforced, Grouted, or Filled with Loose Insulation: Two cell (core) units.
- J. Manufacturer: Obtain masonry units from one manufacturer, of uniform texture and color for each kind required. All concrete masonry units must be certified to contain a minimum of 30 percent pre-consumer (post-industrial) recycled content.

## 2.02 ACCESSORIES

- A. Masonry Wall Reinforcement: Joint reinforcement factory fabricated from cold-drawn steel wire, ASTM A 82, truss or ladder design, with 9 gage deformed steel wire longitudinal rods welded to 9 gage steel wire cross ties spaced 16 inches oc; width 1-1/2 to 2 inches less than total wall thickness. Furnish factory-fabricated corner and tee sections for corners and wall intersections.
  - 1. Finish for Interior Walls: 0.8 oz per sq ft mill galvanized, ASTM A 641, Class 3, except interior walls exposed to moist environment shall have finish specified for exterior walls.
- B. Bar Reinforcement: ASTM A 615, Grade 60, deformed steel bars.
  - 1. Rebar Positioner: Fabricate from galvanized steel wire, 9 gage or 6.5 gage as required. Design to fit concrete masonry units, and number, size and location of rebars indicated. Products; Steel-Wich Telescoping Rebar Positioner or No. 376 Rebar Positioner or No. 377 Rebar Positioner by Heckmann Building Products, Inc., 1501 N. 31st Ave., Melrose Park, IL 60160, (800) 621-4140, [www.heckmannbuildingprods.com](http://www.heckmannbuildingprods.com).
- C. Buck Anchors (For Anchoring New Masonry To Existing Construction): 1-1/4 x 1/8 x 8 inch long Z type steel buck anchor with 2 inch long right angle bent ends, bolt hole in one bent end, 1.5 oz per sq ft hot dipped galvanized after fabrication. Furnish 3/8-inch diameter galvanized machine bolt and non-ferrous metal expansion shield. Metal Lath: Galvanized, expanded metal lath weighing not less than 3.4 pounds per square yard.

## 2.03 SOURCE QUALITY CONTROL

- A. Tests: Sample and test concrete masonry units in accordance with ASTM C 140 and ASTM C 426. Have tests performed by a qualified independent testing laboratory.

## **PART 3 EXECUTION**

### **3.01 PREPARATION**

- A. Allow other trades sufficient opportunity to install built-in Work before proceeding with the walls and partitions. Do not cover pipes, conduit, or ductwork in masonry until directed by the Director's Representative.
- C. Clean off supporting surface under first course of masonry just prior to laying the masonry units.
- D. Protection:
  - 1. Protect face materials against staining.
  - 2. Remove misplaced mortar immediately.
  - 3. Protect sills, ledges, off-sets, and similar items from mortar drippings and other damage during construction.

### **3.02 INSTALLATION**

- A. Install concrete masonry units plumb and true to line in level courses accurately spaced.
- B. Lay masonry units in existing concrete unit masonry bond pattern, and match existing coursing and joints.
- C. Lay only dry masonry units.
- D. Adjust units to final position while mortar is soft and plastic. Remove units disturbed after mortar has stiffened; clean joints and units of mortar and re-lay in fresh mortar.
- E. Lay out Work to avoid use of less than half-size units. Where cutting of masonry units is necessary, cut with a power saw.
- F. Where fresh masonry joins partially or totally set masonry, clean bond surfaces of set masonry, removing loose mortar and foreign material prior to laying fresh masonry.
- G. If it is necessary to stop off a horizontal run of masonry, rack back one-half unit length in each course. Tothing will not be permitted unless approved in writing by the Director's Representative.

### **3.03 INSTALLATION TOLERANCES**

- A. Variation from the Plumb:

1. In the lines and surfaces of columns, walls, and arises:
  - a. In any story: 1/4 inch.

### **3.04 MORTAR BEDS**

- A. Hollow Units:
  1. Lay with full mortar coverage on horizontal and vertical face shells, including bed webs.

### **3.05 JOINTS**

- A. Horizontal and Vertical Face Joints:
  1. Nominal Thickness: 3/8 inch, unless otherwise indicated.
  2. Construct uniform joints.
  3. Strike joints flush in surfaces to be plastered, or surface applied finish other than paint.
  4. Cut joints flush and tool slightly concave on both sides of other walls and partitions, including inner wythe of exterior cavity walls.
- B. Fill horizontal joint between top of masonry partitions and underside of concrete slabs and beams with mortar, unless otherwise shown on the Drawings.
- C. Collar Joints: Except in cavity walls, fill vertical-longitudinal joint between wythes by slushing and rodding the joint full of mortar.
- D. Remove mortar protruding into cells or cavities to be reinforced or filled.

### **3.06 HORIZONTAL JOINT REINFORCEMENT**

- A. Reinforce horizontal joints of concrete unit masonry with continuous masonry wall reinforcement.
- B. Install masonry wall reinforcement in horizontal joints as follows:
  1. Space reinforcement every 16 inches vertically.
  2. Straighten kinks or bends in the wires caused by handling, without injury to the material, before placing in masonry.
  3. Place longitudinal wires over face shell mortar beds.
  4. Embed entire length of longitudinal wires fully in mortar.
  5. Provide minimum mortar cover of 1/2 inch.
  6. Lap ends of adjoining strips of reinforcement 6 inches or more.
  7. Install factory fabricated corner and tee sections at corners and wall intersections respectively.
  - 8.
  9. Install additional lengths of reinforcement in first unreinforced joint above and below openings, centered on opening.

### **3.07 TYING INTERSECTING WALLS AND PARTITIONS**

- A. Except where masonry bond is specified, terminate abutting walls and partitions flush against the face of the abutted walls. Tie intersections at every second course as follows:

1. Non-Load-Bearing Walls: Install ties of masonry wall reinforcement tee sections or strips of hardware cloth embedded in mortar.
  - a. Center standard length masonry wall reinforcement tee sections on the walls.
  - b. Width of hardware cloth strips shall be the width of the abutting wall less 1-1/2 inches; length shall be 24 inches or twice the width of the abutted wall, whichever is greater. Center the strips on the abutting wall and extend across intersection to 3/4 inch from the farthest face of the abutted wall.
- B. Fill vertical joint at abutted walls and partitions solid with mortar at intersection. If a control joint is located at the intersection, rake out both sides of joint to a depth of 3/8 inch.

### **3.08 ANCHORING**

- A. Anchoring Partitions and Infill Abutting Existing Construction: Install buck anchors in bed joints 16 inches oc vertically. Embed one bent end in cell filled with mortar. Install piece of metal lath under the cell to support the mortar filling. Expansion bolt other bent end to existing construction.

### **3.09 REINFORCING WALLS AND PARTITIONS WITH BAR REINFORCEMENT AND GROUT**

- A. Place bar reinforcement in cells and cavities in the masonry where shown on the Drawings. Secure bars in designed locations with rebar positioners.
- B. Grouting: Completely fill cells and cavities in the masonry with grout where shown on the Drawings. Puddle or slightly vibrate grout during placement.
  1. Placement Procedure: Use low-lift grouting procedure. Place in lifts or layers up to maximum of 5 feet in height, except where otherwise shown on the Drawings. Stop level of grout in each lift approximately 1-1/2 inches from top of masonry, except the last lift shall finish flush with the top of masonry.

### **3.10 POINTING AND CLEANING**

- A. Cut off mortar projections remaining from tooling joints.
- B. Dry brush masonry Work after mortar has set, at end of each day's Work and after final pointing.
- C. At completion of masonry Work, fill holes in joints (except weep holes) and tool.
- D. Remove and replace CMU that are loose, chipped, broken, stained, or otherwise damaged, or if units do not match adjacent units. Install new units to match adjoining units in fresh mortar, point joints to eliminate any evidence of block replacement.
- E. Cut out and repoint defective joints.

- F. Leave Work and surrounding surfaces clean and free of mortar spots and droppings.

### **3.11 CONCRETE MASONRY UNIT SCHEDULE**

- A. Unless shown otherwise on the Drawings, use the various kinds of concrete masonry units specified at the locations indicated below:
  - 1. Hollow Non-Load-Bearing Units (Lightweight):
    - a. Use for interior Work.

**END OF SECTION**

**GENERAL PHASING NOTES**

- THE SCHEDULED WORK OF EACH CONTRACT, (C, U, & E, INCLUDING ALLOWANCE SCOPE WITHIN THE E-CONTRACT), FOR EACH PHASE IS TO BE COMPLETED BY ALL CONTRACTS PRIOR TO MOVING ON TO THE NEXT PHASE.
- COMPLETION OF EACH PHASE WILL BE DETERMINED BY THE DIRECTOR'S REPRESENTATIVE AND WILL INVOLVE ALL NECESSARY INSPECTIONS AND / OR PUNCH LIST COMPLETION TO TURN OVER PORTION OF WORK TO THE OWNER FOR USE.
- PHASING IS AS FOLLOWS:
  - PHASE 1: (C, U, & E)
    - SUBMITTALS / SHOP DRAWINGS / FABRICATION.
    - ALL CONSTRUCTION, ESCALATOR, AND ELECTRICAL MATERIALS AND EQUIPMENT FOR PHASE 2A ARE REQUIRED TO BE READY FOR ON-SITE DELIVERY FOR THE START OF PHASE 2A ACTIVITIES.
  - PHASE 2A: (C, U, & E)
    - WORK ASSOCIATED WITH ESCALATORS 17 AND 20, AND RELATED CONSTRUCTION AND ELECTRICAL WORK.
    - ALL CONSTRUCTION, ESCALATOR, AND ELECTRICAL MATERIALS AND EQUIPMENT FOR PHASE 2B ARE REQUIRED TO BE READY FOR ON-SITE DELIVERY FOR THE START OF PHASE 2B ACTIVITIES.
  - PHASE 2B: (C, U, & E)
    - WORK ASSOCIATED WITH ESCALATORS 18 AND 19, AND RELATED CONSTRUCTION AND ELECTRICAL WORK.
    - ALL CONSTRUCTION, ESCALATOR, AND ELECTRICAL MATERIALS AND EQUIPMENT FOR PHASE 3 ARE REQUIRED TO BE READY FOR ON-SITE DELIVERY FOR THE START OF PHASE 3 ACTIVITIES.
  - PHASE 3: (C, U, & E)
    - WORK ASSOCIATED WITH "DOWN" ESCALATORS 9 - 16, AND RELATED CONSTRUCTION AND ELECTRICAL WORK.
    - ALL CONSTRUCTION, ESCALATOR, AND ELECTRICAL MATERIALS AND EQUIPMENT FOR PHASE 4 ARE REQUIRED TO BE READY FOR ON-SITE DELIVERY FOR THE START OF PHASE 4 ACTIVITIES.
    - ESCALATORS 9 - 16 SHALL OPERATE IN THE UPWARD DIRECTION DURING PHASE 4.
  - PHASE 4: (C, U, & E)
    - WORK ASSOCIATED WITH "UP" ESCALATORS 1 - 8, AND RELATED CONSTRUCTION AND ELECTRICAL WORK.
    - AT THE COMPLETION OF PHASE 4, ESCALATORS 9 - 16 SHALL OPERATE IN THE DOWNWARD DIRECTION AND ESCALATORS 1 - 8 SHALL OPERATE IN THE UPWARD DIRECTION.
- ESCALATORS 17, 18, 19, AND 20 WILL NOT BE OPERATIONAL DURING THE ENTIRETY OF PHASE 2. THE SEPARATION OF PHASE 2 INTO PHASE 2A AND 2B IS SPECIFIC TO THE LOCATION OF TEMPORARY PARTITIONS TO MAINTAIN CIRCULATION DURING THE REHABILITATION OF ESCALATORS IN THIS PHASE.

**GENERAL NOTES**

- NO PARKING WILL BE ALLOWED AT THE SITE, EXCEPT FOR VEHICLES TRANSPORTING MATERIAL/EQUIPMENT TO AND FROM THE SITE OR VEHICLES THAT ARE BEING LOADED/UNLOADED.
- ALL DELIVERIES AND REMOVALS, SHALL BE PERFORMED AT TIMES AS COORDINATED WITH DIRECTOR'S REPRESENTATIVE. COORDINATE EXACT ROUTE WITH DIRECTOR'S REPRESENTATIVE. PROVIDE TEMPORARY PROTECTION OF ALL SURFACES DURING DELIVERY AND REMOVAL ACTIVITIES.
- OFF-SITE STORAGE REQUIRED. COORDINATE WITH DIRECTOR'S REPRESENTATIVE FOR ON-SITE STAGING/STORAGE NOTED BELOW. U-CONTRACT PROVIDED WITH LIMITED STORAGE ON THE FOURTH FLOOR
- EACH CONTRACTOR IS RESPONSIBLE FOR SECURING AND PROTECTING ANY STAGING/STORAGE AREAS FROM THE PUBLIC. ANY DAMAGE CAUSED WILL BE THE RESPONSIBILITY OF THE CONTRACTOR TO CORRECT, TO THE SATISFACTION OF THE DIRECTOR'S REPRESENTATIVE WITHOUT ANY ADDITIONAL COSTS TO THE STATE.
- EACH CONTRACTOR IS RESPONSIBLE FOR CLEAN-UP OF ALL WORK AREAS EXPOSED TO THE PUBLIC OR STAFF ON A DAILY BASIS.
- CONTRACTOR DELIVERIES, LOADING, UNLOADING, STAGING AND LOCATIONS OF TEMPORARY PARTITIONS SHALL NOT OBSTRUCT FIRE LANES, EGRESS ROUTES AND DOORS SHALL REMAIN OPEN AT ALL TIMES.
- CONTRACTORS WILL HAVE USE OF ONE STAFF ELEVATOR COORDINATED WITH THE DIRECTOR'S REPRESENTATIVE DURING EACH PHASE FOR THE MOVEMENT OF MATERIALS, EQUIPMENT, AND WORKERS. PUBLIC ELEVATORS ARE NOT TO BE USED FOR ANY REASON BY CONTRACTORS.
- INSTALLATION AND BREAKDOWN OF TEMPORARY PARTITIONS SHALL BE PERFORMED AT TIMES AS COORDINATED WITH DIRECTOR'S REPRESENTATIVE.
- CONCURRENT WORK IS BEING PERFORMED AT THIS FACILITY UNDER SEPARATE CONTRACTS, UNRELATED TO CONTRACT 47028. COORDINATE ALL WORK PERFORMED WITH DIRECTOR'S REPRESENTATIVE.
- TWO DESKS WILL BE MADE AVAILABLE FOR USE BY THE U-CONTRACT IN THE FACILITY MANAGERS OFFICE.
- ESCALATOR #1-#16 - SCHEDULED EQUIPMENT AND MATERIAL INCLUDING DEMOLITION REMOVALS TO BE TRANSPORTED FROM BASEMENT LOADING DOCK TO LANDINGS SERVED BY FREIGHT ELEVATOR #10. CONTRACTOR IS REQUIRED TO PROVIDE ALL MATERIAL HANDLING NEEDS AND SUPPORT EQUIPMENT.

**GENERAL NOTES - CONTINUED**

- ESCALATOR #17-#20- SCHEDULED EQUIPMENT AND MATERIAL INCLUDING DEMOLITION REMOVALS TO BE TRANSPORTED FROM PARK AVENUE STUDENT CENTER DROP OFF LOCATION, OR ALTERNATE ROUTE AS COORDINATED WITH AND APPROVED BY DIRECTOR'S REPRESENTATIVE.
- FREIGHT ELEVATOR #10, (10,000 LB. CAPACITY) MAY BE USED FOR MATERIAL MOVEMENT AS COORDINATED WITH THE DIRECTOR'S REPRESENTATIVE.

**CODE COMPLIANCE**

- APPLICABLE BUILDING CODE:**  
UNIFORM FIRE PREVENTION AND BUILDING CODE:
- 2020 BUILDING CODE OF NEW YORK STATE
  - 2020 EXISTING BUILDING CODE OF NEW YORK STATE
  - 2020 ENERGY CONSERVATION CODE OF NEW YORK STATE
  - NFPA 70 NATIONAL ELECTRICAL CODE - 2017
  - NFPA 72 NATIONAL FIRE ALARM AND SIGNALING CODE - 2016
  - NFPA 80 STANDARD FOR FIRE DOORS & OTHER OPENING DEVICES
  - 2020 MECHANICAL CODE OF NEW YORK STATE
  - 2020 PLUMBING CODE OF NEW YORK STATE
  - ASME A17.1 ELEVATOR CODE - 2016
  - ICC A117.1-2009
  - ADA 2010
  - HOISTWAY VENTILATION - MAINTAIN IN COMPLIANCE WITH CODE IN AFFECT AT TIME OF CONSTRUCTION
- GENERAL CODE INFORMATION:**
- USE AND OCCUPANCY CLASSIFICATION: MIXED USE: A-1, A-2, A-3, B, S
  - CLASSIFICATION OF WORK: ALTERATION LEVEL 1
    - ALTERATION LEVEL 1: ESCALATOR MODERNIZATIONS
    - ALTERATION LEVEL 1: FIRE SHUTTER REPLACEMENTS
  - TYPE OF CONSTRUCTION: CONSTRUCTION TYPE: ASSUMED TYPE 1A
- FIRE RESISTANCE REQUIREMENTS FOR BUILDING ELEMENTS (TABLE 601):**
- SPRINKLER PROTECTED: PARTIAL
  - PRIMARY STRUCTURE: 3 HOURS
  - EXTERIOR AND INTERIOR LOAD BEARING WALLS: 3 HOURS
  - INTERIOR NON-LOAD BEARING WALLS: 0 HOURS
  - FLOORS: 2 HOURS
  - ROOF: 1 1/2 HOUR TYP.  
0 HOUR AT ELEVATOR SHAFT OVERHEAD SHEAVE SPACE.  
- PER NOTE B: NO RATING REQUIRED WHERE ROOF AND FRAMING ARE 20 FEET OR MORE ABOVE FLOOR IMMEDIATELY BELOW.

**FIRE/SMOKE SEPARATION ASSEMBLIES:**

- EXIT ENCLOSURES (1023.2): 2 HOURS
- SHAFT ENCLOSURES (712 & 713): 2 HOURS
- CORRIDORS (TABLE 1020.1): 1 HOUR
- INCIDENTAL USES (TABLE 509): N/A

**EXITING:**

- EXISTING MEANS OF EGRESS SHALL NOT BE MODIFIED BY THE USE OF TEMPORARY PARTITIONS DURING THE PERFORMANCE OF THIS CONTRACT. TEMPORARY PARTITIONS HAVE BEEN REFLECTED ON THE 47028-U CONTRACT DRAWINGS AND ARE LIMITED TO THE PROTECTION OF THE ELEVATOR ENTRANCES FOR THE PERFORMANCE OF CONTRACT WORK.

**SAFEGUARDS DURING CONSTRUCTION:**

- COMPLY WITH THE FOLLOWING REQUIREMENTS DURING CONSTRUCTION INCLUDING, BUT NOT LIMITED TO:
- OSHA (OCCUPATIONAL SAFETY AND HEALTH ADMINISTRATION)
  - BCNYS CHAPTER 33 SAFEGUARDS DURING CONSTRUCTION
  - BCNYS CHAPTER 15 CONSTRUCTION SAFEGUARDS
  - FCNYS CHAPTER 33 FIRE SAFETY DURING CONSTRUCTION AND DEMOLITION

NOTE: REFER TO SPECIFICATION SECTION 014100 REGULATORY REQUIREMENTS FOR ADDITIONAL INFORMATION. DEMONSTRATE COMPLIANCE WITH REGULATORY REQUIREMENTS IN THE SITE SPECIFIC SAFETY PLAN.

**FIRE SHUTTERS: ALTERATION - LEVEL 1**

- THE SCOPE OF THIS PROJECT WILL REMOVE AND REPLACE THE EXISTING FIRE SHUTTER WITH A NEW FIRE SHUTTER THAT SERVES THE SAME PURPOSE AND IN THE SAME CONFIGURATION.
- NYSBC 2020, SECTION 301.3:** ALTERATION SHALL COMPLY WITH ONE OF THE COMPLIANCE PATHS, (PRESCRIPTIVE, WORK AREA, OR PERFORMANCE)
  - EXCEPTION: SUBJECT TO THE APPROVAL OF THE BUILDING OFFICIAL, ALTERATIONS COMPLYING WITH THE LAWS IN EXISTENCE AT THE TIME THE BUILDING OR THE AFFECTED PORTION OF THE BUILDING WAS BUILT SHALL BE CONSIDERED IN COMPLIANCE WITH THE PROVISIONS OF THIS CODE.
- NYSBC 2020, SECTION 701.2 CONFORMANCE:** AN EXISTING BUILDING OR PORTION THEREOF SHALL NOT BE ALTERED SUCH THAT THE BUILDING BECOMES LESS SAFE THAN ITS EXISTING CONDITION.
  - ADDITIONAL SAFETY MEASURES:
    - EMERGENCY CALL STATIONS WILL BE PROVIDED AT ALL LANDINGS WITH A FIRE SHUTTER TO ALLOW EMERGENCY PERSONNEL TO KNOW OF ANY ENTRAPMENTS BY AN INDIVIDUAL UNABLE TO ASCEND OR DESCEND ON THEIR OWN TO SAFETY.
    - FEO-K1 MOMENTARY KEYSWITCHES WILL BE PROVIDED AT THE CONCOURSE/(BASEMENT) LEVEL AND THE FIRST FLOOR LEVEL TO ALLOW EMERGENCY PERSONNEL TO MOMENTARILY OPEN THE FIRE SHUTTERS TO AID IN THE EXTRACTION OF ANY INDIVIDUAL(S) UNABLE TO EVACUATE IN AN EMERGENCY.

**HAZARDOUS MATERIALS AWARENESS:**

- ACM: TESTING FOR ACM ASSOCIATED WITH THE ESCALATORS AND SPECIFIC TO THIS PROJECT'S SCOPE OF WORK WAS PERFORMED. THERE WERE NO ASBESTOS FINDINGS RELATED TO THE ESCALATORS.
- LBP: TESTING FOR LBP ASSOCIATED WITH THE ESCALATORS AND SPECIFIC TO THE PROJECT'S SCOPE OF WORK WAS PERFORMED. THERE ARE NO LBP FINDINGS RELATED TO THE ESCALATORS.
- THE RENOVATION SURVEY FOR ASBESTOS-CONTAINING MATERIALS, LEAD-BASED PAINT & PCBs, DATED JUNE 22, 2022, IS IN THE APPENDIX OF THE PROJECT MANUAL.

**CODE COMPLIANCE STATEMENT:**

- CODE REFERENCE AND ENERGY CONSERVATION CONSTRUCTION CODE OF NEW YORK STATE.
- ENERGY CODE STATEMENT: TO THE BEST OF THE REGISTERED DESIGN PROFESSIONAL'S KNOWLEDGE, BELIEF, AND PROFESSIONAL JUDGEMENT, THESE PLANS AND/OR SPECIFICATIONS ARE IN COMPLIANCE WITH THE 2020 ENERGY CODE.
  - UNIFORM CODE STATEMENT: TO THE BEST OF THE REGISTERED DESIGN PROFESSIONAL'S KNOWLEDGE, BELIEF, AND PROFESSIONAL JUDGEMENT, THESE PLANS AND/OR SPECIFICATIONS ARE IN COMPLIANCE WITH THE 2020 UNIFORM CODE.

**ALLOWANCE INFORMATION**

- CONCURRENT WORK IS BEING PROVIDED UNDER SEPARATE ALLOWANCES RELATED TO THESE DOCUMENTS SCOPE OF WORK FOR FIRE ALARM AND EMERGENCY COMMUNICATIONS. WORK SHALL BE COORDINATED BETWEEN EACH TRADES WORK.
  - HONEYWELL (FIRE ALARM VENDOR) SHALL PROVIDE ALL DEVICES, PROGRAMMING, AND TESTING. THE ELECTRICAL CONTRACTOR SHALL PROVIDE INFRASTRUCTURE FOR FIRE ALARM SCOPE INCLUDING ALL RACEWAYS, CONDUIT, WIRING, BACKBOXES, DEVICE INSTALLATION, AND FINAL CONNECTIONS.
  - ALARM & SUPPRESSION (EMERGENCY COMMUNICATIONS VENDOR) SHALL PROVIDE ALL DEVICES, PROGRAMMING, DEVICE INSTALLATION AND TESTING. THE ELECTRICAL CONTRACTOR SHALL PROVIDE INFRASTRUCTURE FOR EMERGENCY COMMUNICATION SCOPE INCLUDING ALL RACEWAYS, CONDUIT, WIRING, BACKBOXES, FINAL CONNECTION OF DEVICE AND INSTALLATION OF MODIFIED AED CABINETS.

**SITE PLAN LEGEND**

- MER 1 AREA - FOR USE BY C, U, AND E CONTRACT FOR STAGING/STORAGE WITH ACCESS FROM P2. (PLAZA SIDE) AND LOADING DOCK AT BASEMENT LEVEL, BELOW MADISON AVENUE.

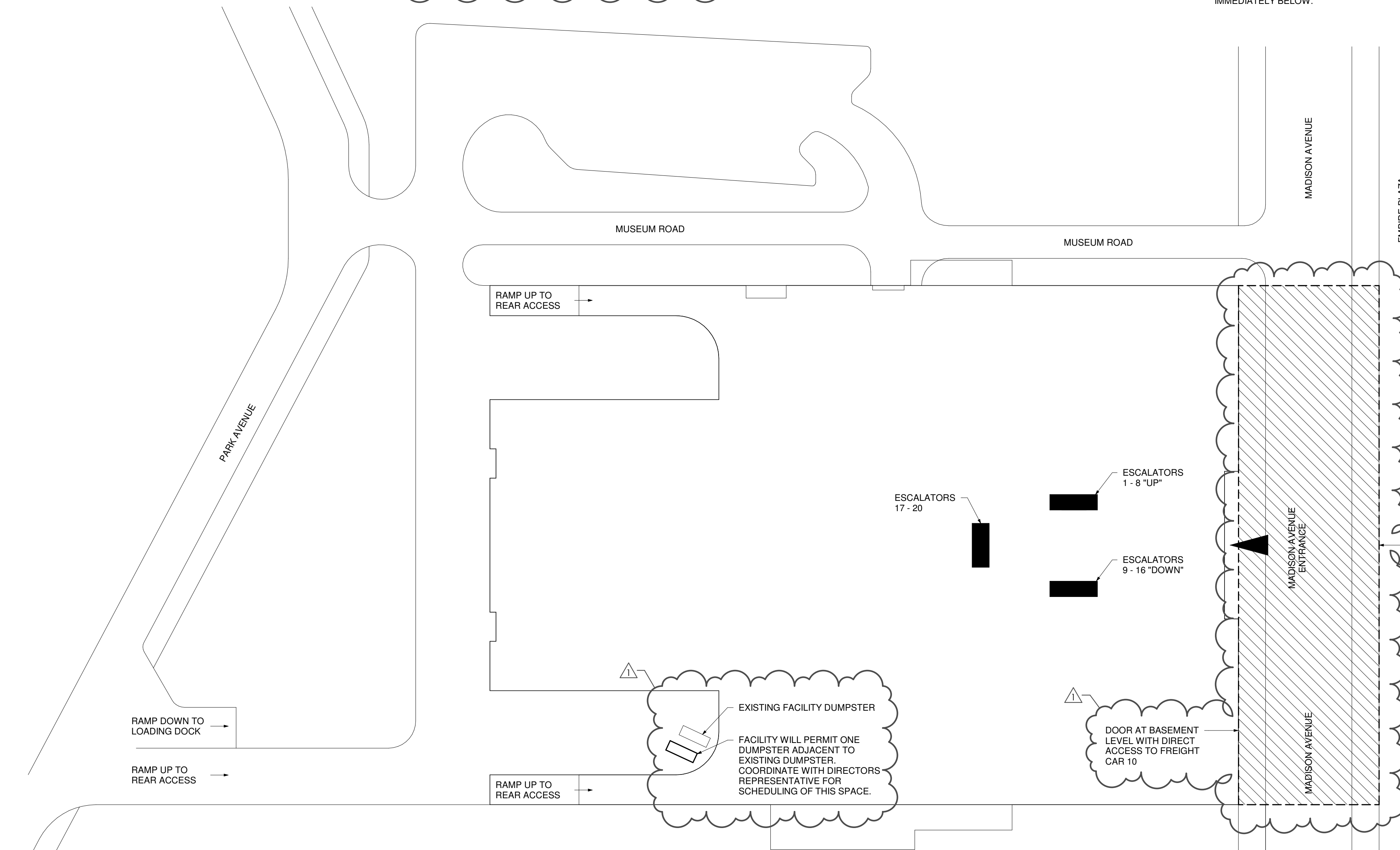

**1 SITE PLAN / FIRST FLOOR SCHEMATIC LOCATION REFERENCE PLAN**  
1" = 50'-0"

**DESIGN & CONSTRUCTION**

CONSULTANT  
CERTIFICATE OF AUTHORIZATION #: 1127432



**WARNING:**  
THE ALTERATION OF THIS MATERIAL IN ANY WAY, UNLESS DONE UNDER THE DIRECTION OF A COMPARABLE PROFESSIONAL, I.E. ARCHITECT FOR AN ARCHITECT, ENGINEER FOR AN ENGINEER OR LANDSCAPE ARCHITECT FOR A LANDSCAPE ARCHITECT, IS A VIOLATION OF THE NEW YORK STATE EDUCATION LAW AND/OR REGULATIONS AND IS A CLASS 'A' MISDEMEANOR.



REGISTRATION EXPIRES: 12/31/2026

CONTRACT: CONSTRUCTION, ESCALATOR, & ELECTRICAL

TITLE: **REHABILITATE ESCALATORS**

LOCATION: CULTURAL EDUCATION CENTER  
EMPIRE STATE PLAZA  
ALBANY, NY

CLIENT: OFFICE OF GENERAL SERVICES

MARK	DATE	DESCRIPTION
1	4.29.2025	REVISED DRAWING
	03.20.2025	BID DOCUMENTS

PROJECT NUMBER: **47028 -C, U, & E**

DESIGNED BY: AJR

DRAWN BY: RTR

FIELD CHECK:

APPROVED:

SHEET TITLE:

**CODE INFORMATION AND SITE PLAN**

DRAWING NUMBER: **G-101**

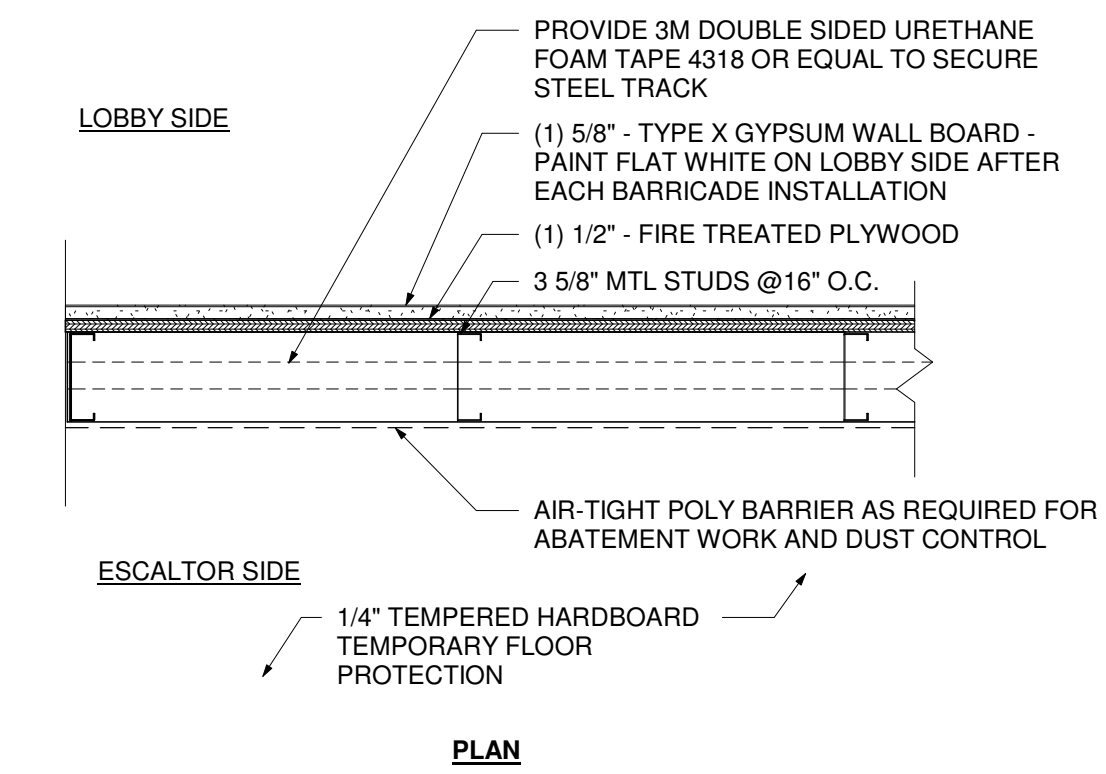
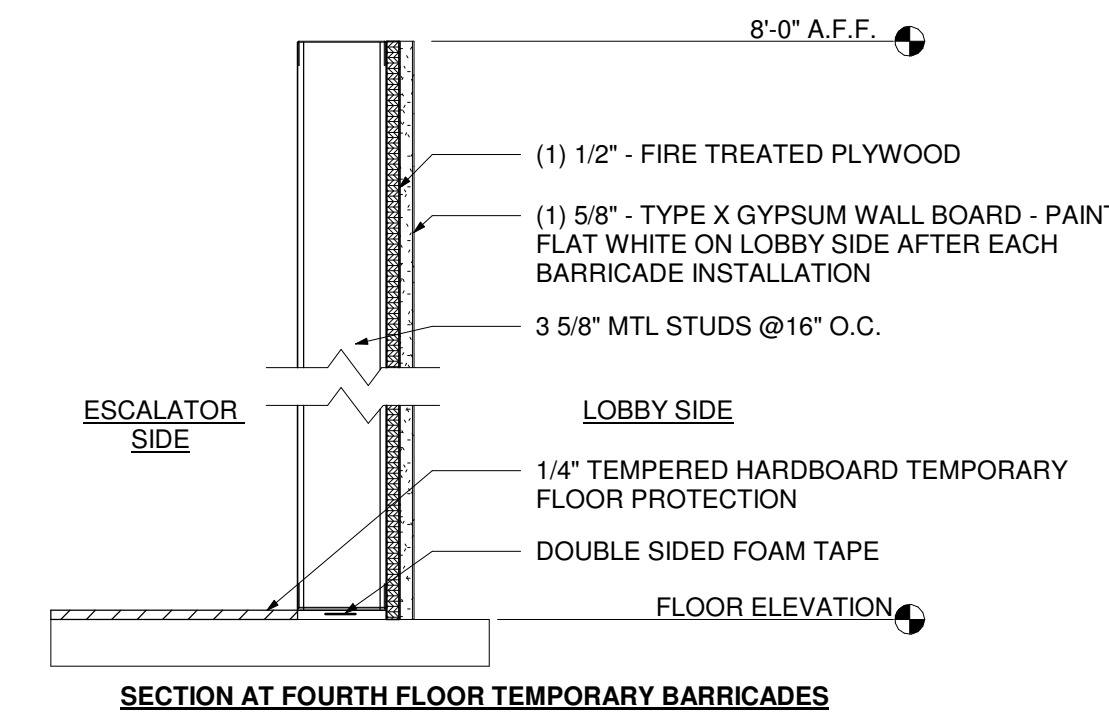
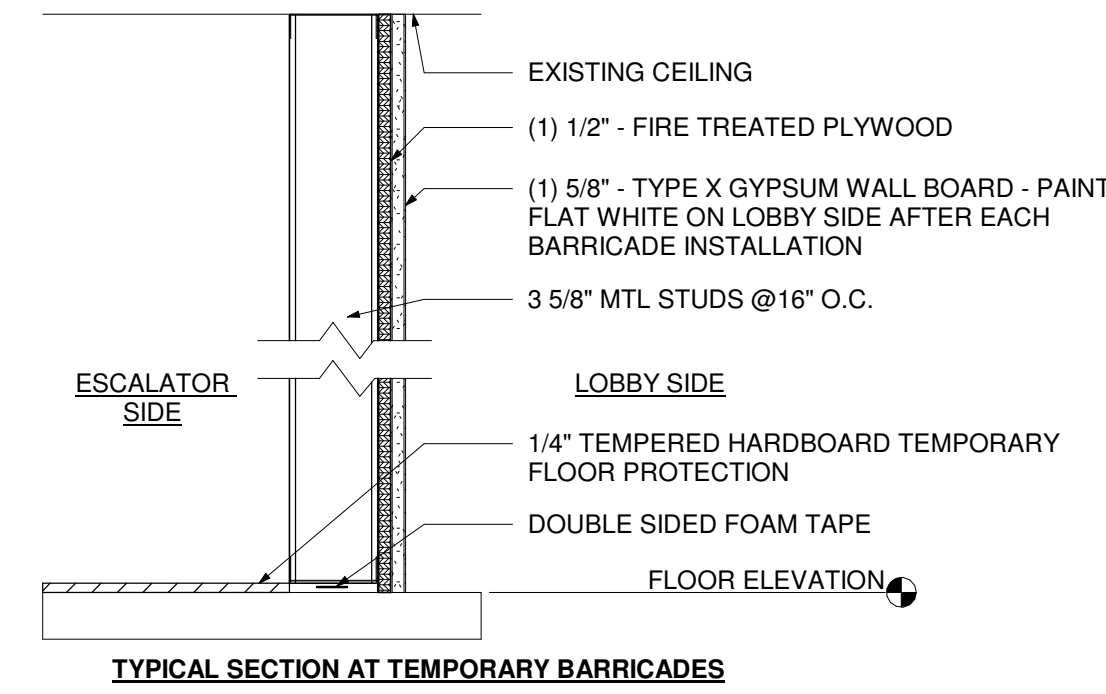
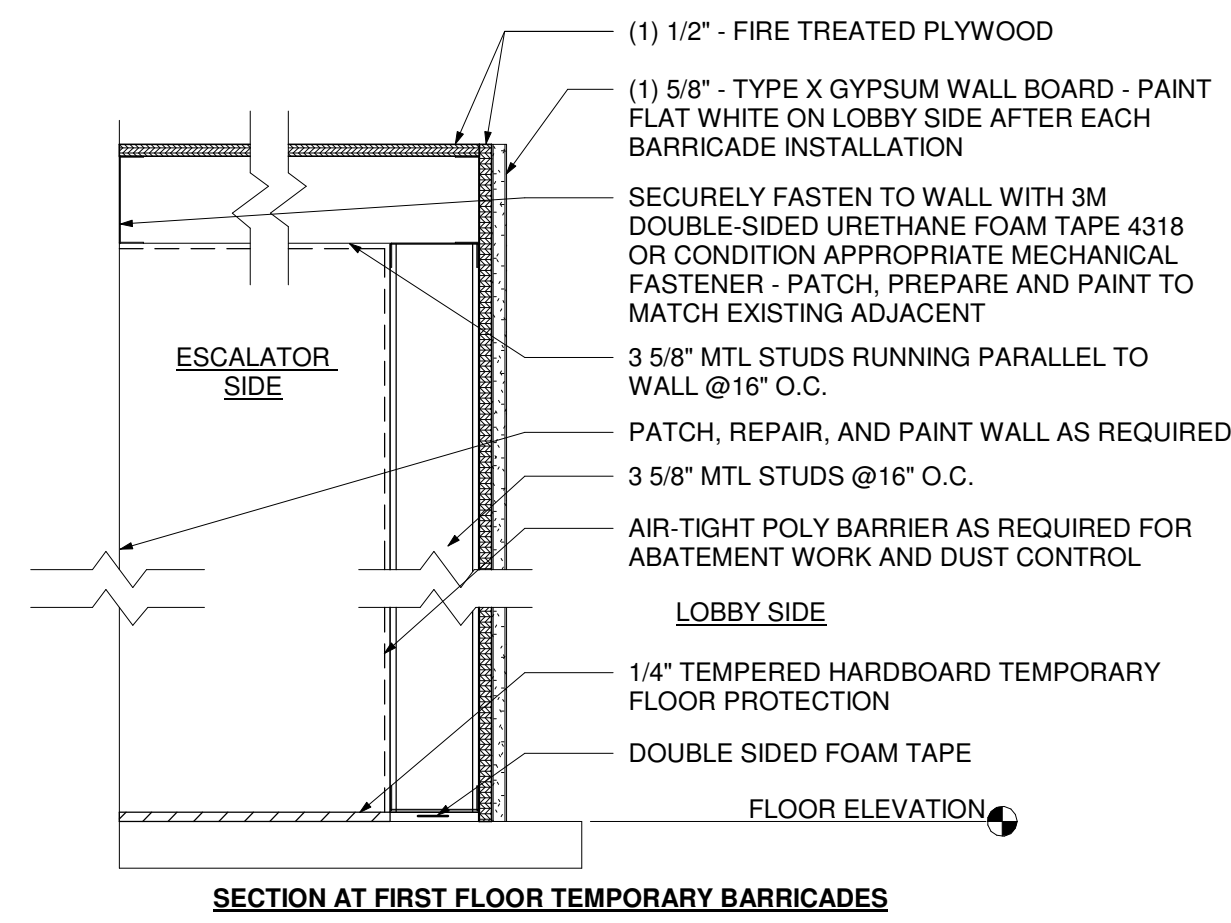

**OVERALL PLAN LEGEND**

- ESCALATORS
- E# ESCALATOR (NUMBER)

**DRAWING NOTES**

- 072 PROVIDE TEMPORARY PARTITION ENCLOSURE FOR THE DURATION OF PHASE 3 AND PHASE 4 WORK ACTIVITIES - COORDINATE WITH U-C CONTRACT AND DIRECTORS REPRESENTATIVE FOR LAYOUT

**NOTES:**

1. UNLESS OTHERWISE NOTED, TEMPORARY BARRICADES SHALL BE PROVIDED AS DETAILED.
2. PROVIDE AND MAINTAIN HARDWALL BARRICADES AS SHOWN AND DETAILED. COORDINATE EXTENT OF WORK WITH EACH RESPECTIVE CONTRACT. HARDWALL BARRICADES SHALL BE PAINTED AFTER EACH INSTALLATION.
3. MATERIALS AND EQUIPMENT ASSOCIATED WITH TEMPORARY BARRICADES AND CONTROL MEASURES SHALL BE STORED OFFSITE WHEN NOT IN USE.
4. PROVIDE (2) 36" X 84" HOLLOW METAL DOUBLE DOORS AT EACH TEMPORARY BARRICADE UNLESS SHOWN OTHERWISE. DOUBLE DOORS SHALL HAVE ONE ACTIVE LEAF AND ONE PASSIVE LEAF. SINGLE DOORS TO BE 36" X 84".

**HARDWARE (DOUBLE DOORS)**

- 6 HINGES
- 1 FLUSH BOLT (OVERHEAD)
- 1 MORTISE LOCKSET - STOREROOM FUNCTION
- 1 CYLINDER
- 2 CLOSERS WITH STOP ARM
- 1 COORDINATOR
- 1 ASTRAGAL
- 1 SILENCERS

**HARDWARE (SINGLE DOORS)**

- 3 HINGES
- 1 MORTISE LOCKSET - STOREROOM FUNCTION
- 1 CYLINDER
- 1 CLOSER
- 1 WALL STOP
- 1 SILENCERS

**2 TEMPORARY PARTITION DETAILS**

1 1/2" = 1'-0"

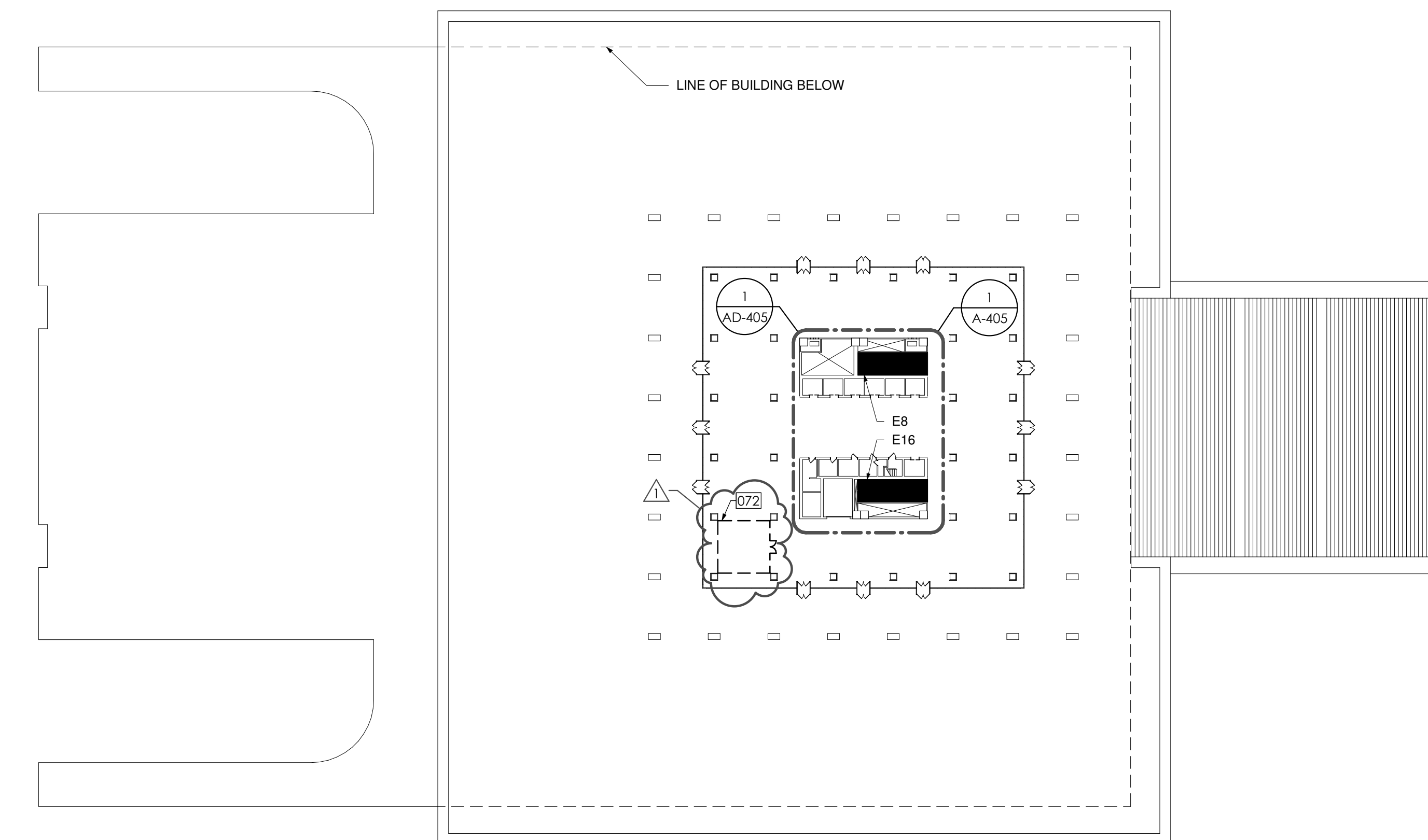

**1 OVERALL FOURTH FLOOR PLAN**

1" = 50'-0"

**DESIGN & CONSTRUCTION**

CONSULTANT  
CERTIFICATE OF AUTHORIZATION #: 1127432



**WARNING:**

THE ALTERATION OF THIS MATERIAL IN ANY WAY, UNLESS DONE UNDER THE DIRECTION OF A COMPARABLE PROFESSIONAL, I.E. ARCHITECT FOR AN ARCHITECT, ENGINEER FOR AN ENGINEER OR LANDSCAPE ARCHITECT FOR A LANDSCAPE ARCHITECT, IS A VIOLATION OF THE NEW YORK STATE EDUCATION LAW AND/OR REGULATIONS AND IS A CLASS 'A' MISDEMEANOR.



REGISTRATION EXPIRES: 12/31/2026

**CONSTRUCTION**

TITLE: **REHABILITATE ESCALATORS**

LOCATION: **CULTURAL EDUCATION CENTER  
EMPIRE STATE PLAZA  
ALBANY, NY**

CLIENT: **OFFICE OF GENERAL SERVICES**

REVISIONS		
MARK	DATE	DESCRIPTION
1	4.28.2025	REVISED DRAWING
	03.20.2025	BID DOCUMENTS

PROJECT NUMBER: **47028 - C**

DESIGNED BY: **AJR**

DRAWN BY: **RTR**

FIELD CHECK:

APPROVED:

SHEET TITLE:

**GENERAL NOTES,  
LEGENDS, AND OVERALL  
FLOOR PLANS**

DRAWING NUMBER:  
**A-102**

**REMOVAL DRAWING NOTES** #

- D05 REMOVE GLASS GUARD ASSEMBLY IN ITS ENTIRETY INCLUDING SECUREMENT HARDWARE AND SAFEGUARD FOR REINSTALLATION AT COMPLETION OF ESCALATOR INSTALLATION - PROVIDE FALL PROTECTION AS REQUIRED UNTIL GUARD IS REINSTALLED - COORDINATE WITH ESCALATOR CONTRACT
- D06 ESCALATOR REMOVAL BY ESCALATOR CONTRACT

**DRAWING NOTES** #

- 009 PROVIDE TEMPORARY 18' X 24' SIGNAGE INDICATING "ESCALATOR OUT OF SERVICE. WE APOLOGIZE FOR ANY INCONVENIENCE" - COORDINATE EXACT LOCATION OF SIGNAGE WITH DIRECTOR'S REPRESENTATIVE AND PROVIDE SIGNAGE INDICATING LOCATION OF ELEVATORS / ESCALATORS AVAILABLE FOR PUBLIC USE
- 010 PROVIDE TEMPORARY PARTITION ENCLOSURE FOR THE DURATION OF PHASE 3 WORK ACTIVITIES - COORDINATE WITH U-CONTRACT AND DIRECTOR'S REPRESENTATIVE FOR LAYOUT
- 011 PROVIDE TEMPORARY PARTITION ENCLOSURE FOR THE DURATION OF PHASE 4 WORK ACTIVITIES - COORDINATE WITH U-CONTRACT AND DIRECTOR'S REPRESENTATIVE FOR LAYOUT
- 073 ADDITIONAL STORAGE AREA - REFER TO 1/A-102 FOR EXACT LOCATION

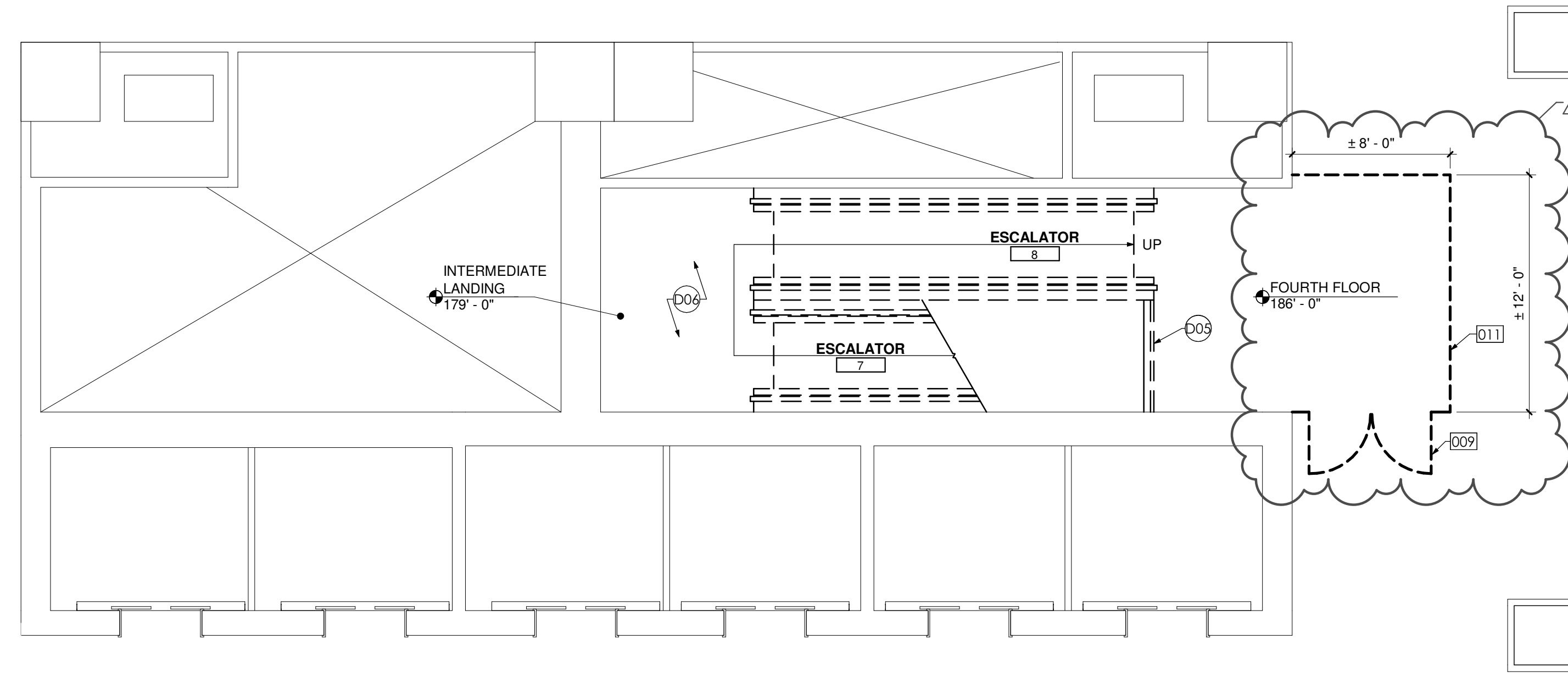
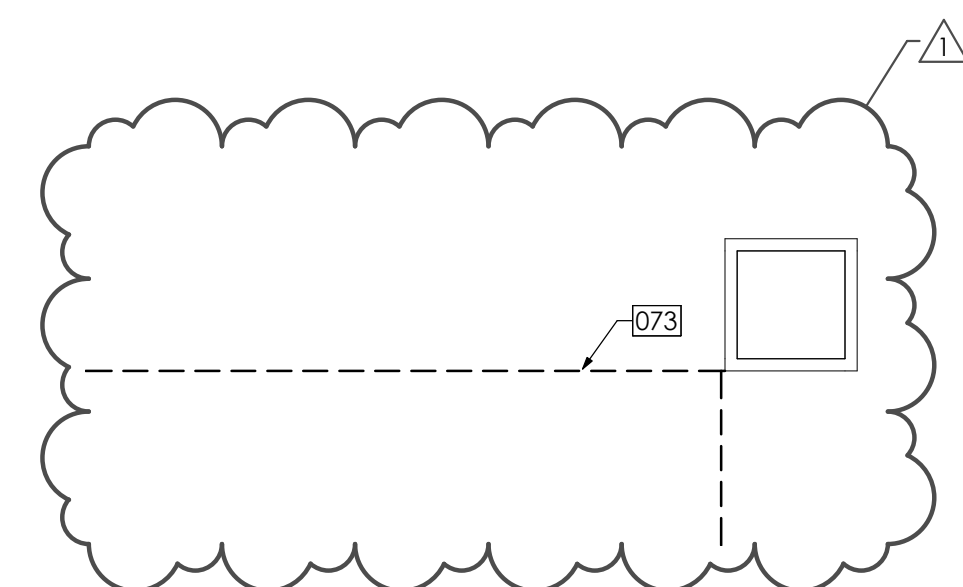
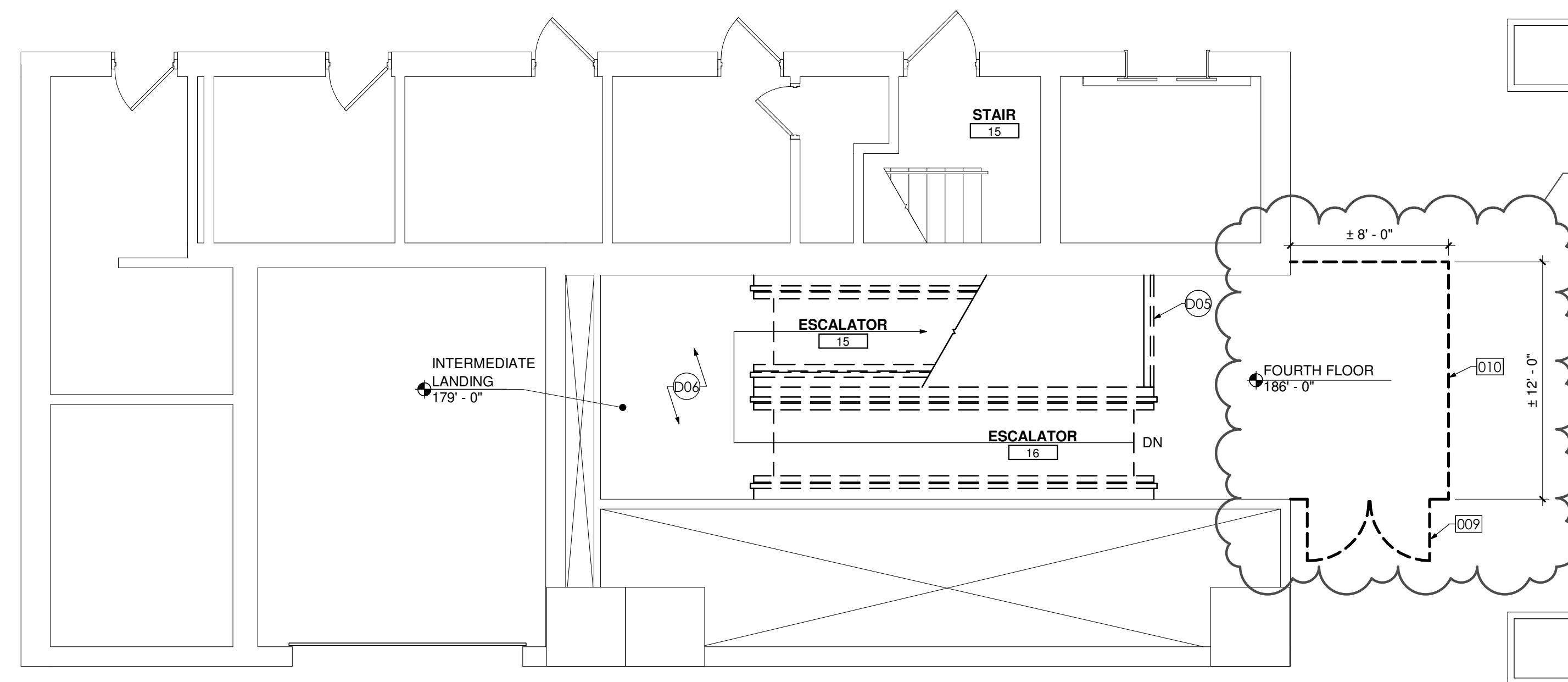

EXHIBIT AREA

ELEVATOR LOBBY

EXHIBIT AREA



**1 ENLARGED FOURTH FLOOR PLAN - REMOVAL**  
3/16" = 1'-0"

**DESIGN & CONSTRUCTION**

CONSULTANT  
CERTIFICATE OF AUTHORIZATION #: 1127432



Architectural Resources



**WARNING:**  
THE ALTERATION OF THIS MATERIAL IN ANY WAY, UNLESS DONE UNDER THE DIRECTION OF A COMPARABLE PROFESSIONAL, I.E. ARCHITECT FOR AN ARCHITECT, ENGINEER FOR AN ENGINEER OR LANDSCAPE ARCHITECT FOR A LANDSCAPE ARCHITECT, IS A VIOLATION OF THE NEW YORK STATE EDUCATION LAW AND/OR REGULATIONS AND IS A CLASS 'A' MISDEMEANOR.



REGISTRATION EXPIRES: 12/31/2026

**CONSTRUCTION**

TITLE: **REHABILITATE ESCALATORS**

LOCATION: CULTURAL EDUCATION CENTER  
EMPIRE STATE PLAZA  
ALBANY, NY

CLIENT: OFFICE OF GENERAL SERVICES

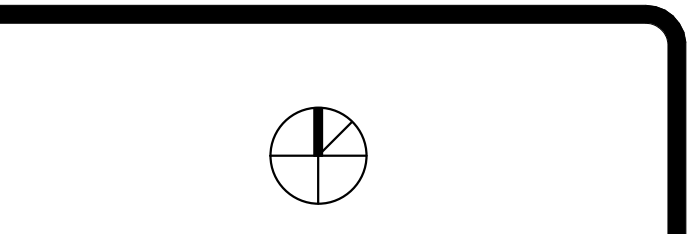

MARK	DATE	DESCRIPTION
1	4.28.2025	REVISED DRAWING
	03.20.2025	BID DOCUMENTS

PROJECT NUMBER: **47028 - C**  
DESIGNED BY: AJR  
DRAWN BY: RTR  
FIELD CHECK:  
APPROVED:  
SHEET TITLE:

**ENLARGED REMOVAL PLAN - FOURTH FLOOR**

DRAWING NUMBER: **AD-405**

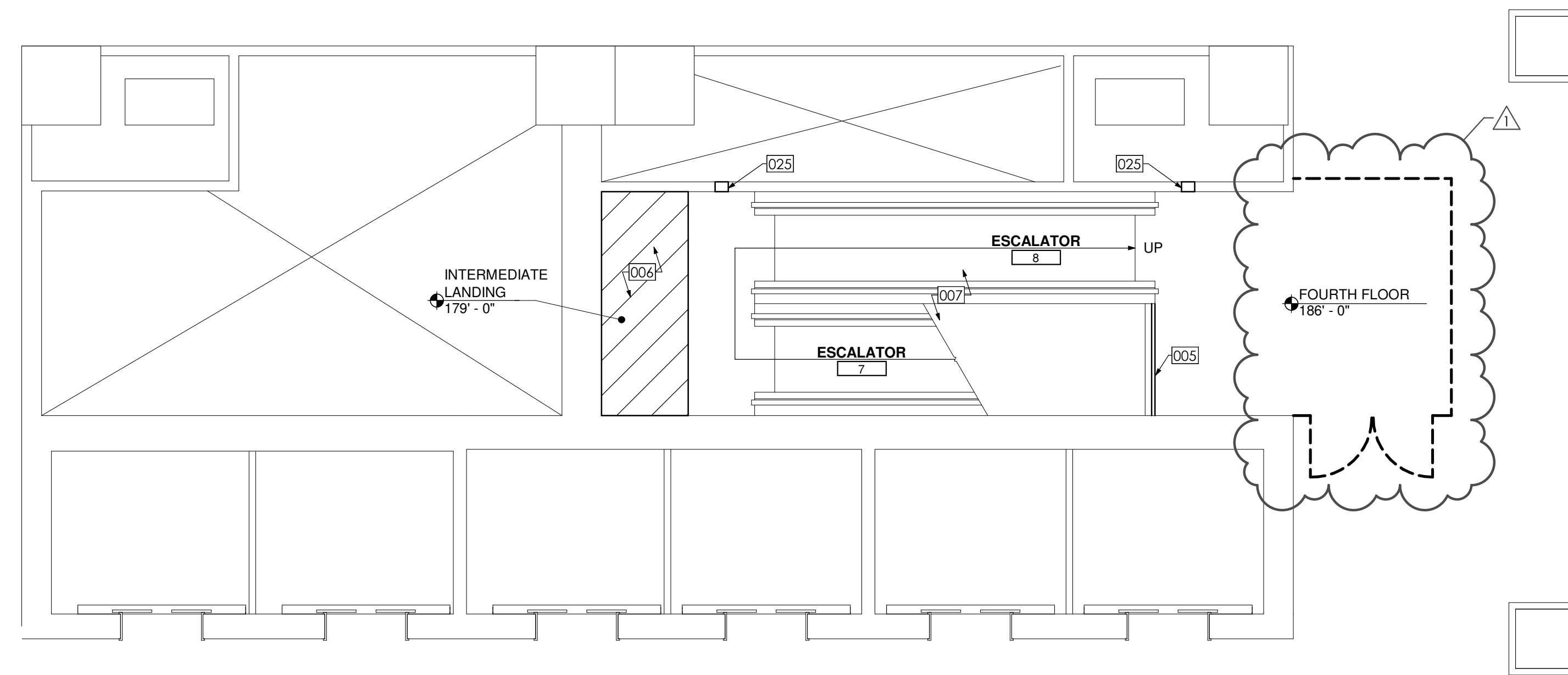

ELEVATOR LOBBY

EXHIBIT AREA

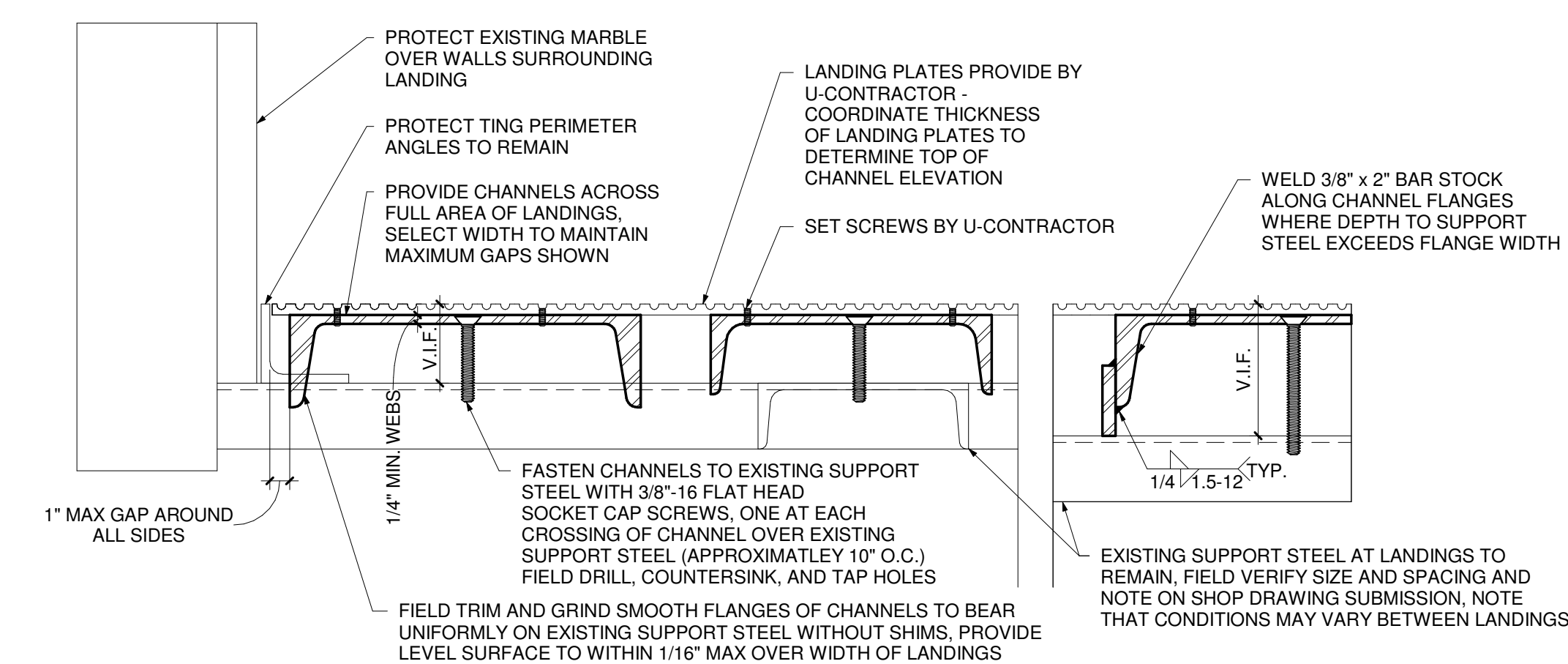
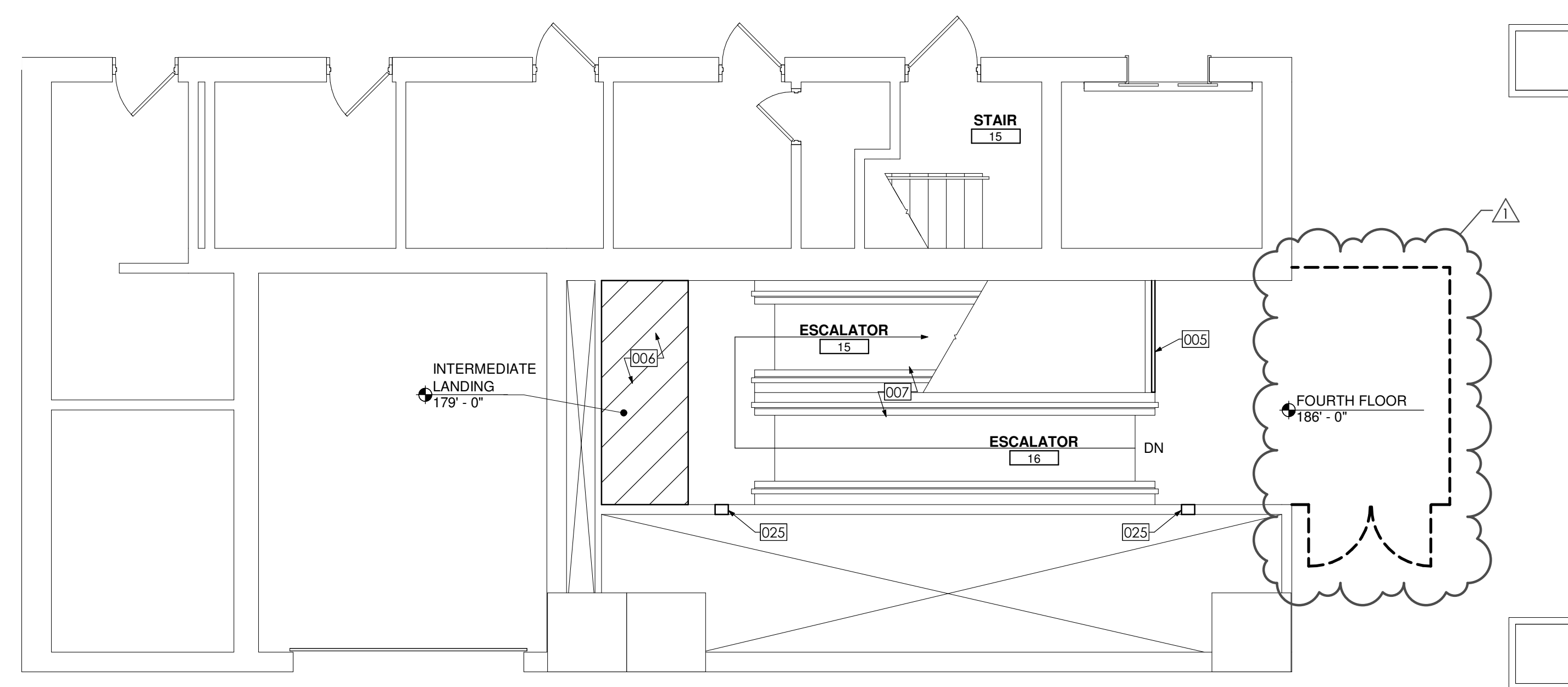

**DRAWING NOTES**

- 005 REINSTALL GLASS GUARD ASSEMBLY AT COMPLETION OF ESCALATOR INSTALLATION - PROVIDE BRONZE BRACKET FOR CONNECTION TO ESCALATOR SIDEWALL IF THE EXISTING BRACKET CAN NOT BE CONFIGURED TO WORK
- 006 COORDINATE WITH ESCALATOR CONTRACT TO PROVIDE SUB-FRAMING MOUNTED TO PRIMARY FRAMING, AT DEPTH NECESSARY, SPACED, AND LOCATED IN COORDINATION WITH THE INSTALLATION OF LANDING PLATES SUCH THAT ALL LANDING PLATES ARE INSTALLED FLUSH TO ADJACENT PIT ACCESS PLATES - REFER TO DETAIL 2/A-405
- 007 ESCALATOR BY ESCALATOR CONTRACT
- 025 PROVIDE 24-GAUGE MINIMUM STEEL SLEEVE FULL DEPTH OF WALL, SECURED TO EXISTING 6X8 RETURN AIR DUCT LOCATED BELOW THE LANDING PLATE - ANCHOR DUCT TO THE SLEEVE WITH 4 SHEET METAL SCREWS PER SIDE, (TOP, BOTTOM, FRONT AND BACK OF EACH SIDE) - FIRE CAULK PERIMETER VOID BETWEEN DUCT AND CMU TO MAINTAIN FIRE RATING

**DESIGN & CONSTRUCTION**

CONSULTANT  
CERTIFICATE OF AUTHORIZATION #: 1127432



Architectural Resources



**WARNING:**

THE ALTERATION OF THIS MATERIAL IN ANY WAY, UNLESS DONE UNDER THE DIRECTION OF A COMPARABLE PROFESSIONAL, I.E. ARCHITECT FOR AN ARCHITECT, ENGINEER FOR AN ENGINEER OR LANDSCAPE ARCHITECT FOR A LANDSCAPE ARCHITECT, IS A VIOLATION OF THE NEW YORK STATE EDUCATION LAW AND/OR REGULATIONS AND IS A CLASS 'A' MISDEMEANOR.



REGISTRATION EXPIRES: 12/31/2026

**CONSTRUCTION**

TITLE: **REHABILITATE ESCALATORS**

LOCATION: CULTURAL EDUCATION CENTER  
EMPIRE STATE PLAZA  
ALBANY, NY

CLIENT: OFFICE OF GENERAL SERVICES



MARK	DATE	DESCRIPTION
1	4.28.2025	REVISED DRAWING
	03.20.2025	BID DOCUMENTS

PROJECT NUMBER: **47028 - C**

DESIGNED BY: AJR

DRAWN BY: RTR

FIELD CHECK:

APPROVED:

SHEET TITLE:

**ENLARGED PLAN - FOURTH FLOOR**

DRAWING NUMBER: **A-405**

**1 ENLARGED FOURTH FLOOR PLAN**  
3/16" = 1'-0"

**2 LANDING PLATE DETAIL**  
3" = 1'-0"



**OVERALL PLAN LEGEND**

■ ESCALATORS

E# ESCALATOR (NUMBER)

**DRAWING NOTES** #

505 TEMPORARY WALL BY C-CONTRACT - COORDINATE WITH C-CONTRACT AND DIRECTOR'S REPRESENTATIVE FOR REQUIRED LAYOUT

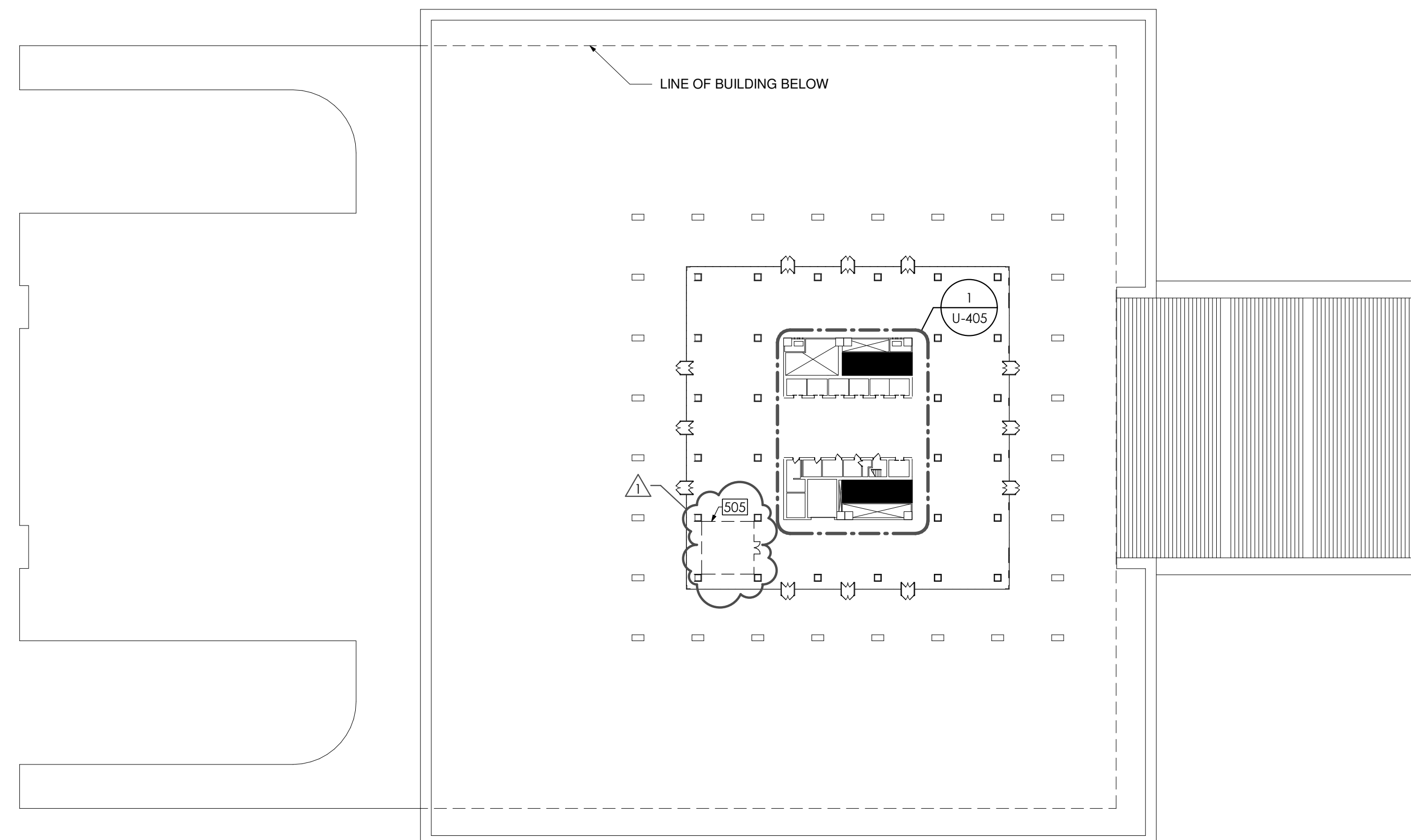

**1 OVERALL FOURTH FLOOR PLAN**  
1" = 50'-0"

**DESIGN & CONSTRUCTION**

CONSULTANT  
CERTIFICATE OF AUTHORIZATION #: 1127432



**WARNING:**  
THE ALTERATION OF THIS MATERIAL IN ANY WAY, UNLESS DONE UNDER THE DIRECTION OF A COMPARABLE PROFESSIONAL, I.E. ARCHITECT FOR AN ARCHITECT, ENGINEER FOR AN ENGINEER OR LANDSCAPE ARCHITECT FOR A LANDSCAPE ARCHITECT, IS A VIOLATION OF THE NEW YORK STATE EDUCATION LAW AND/OR REGULATIONS AND IS A CLASS 'A' MISDEMEANOR.



REGISTRATION EXPIRES: 12/31/2026

CONTRACT: **ESCALATOR**  
TITLE: **REHABILITATE ESCALATORS**  
LOCATION: CULTURAL EDUCATION CENTER  
EMPIRE STATE PLAZA  
ALBANY, NY  
CLIENT: OFFICE OF GENERAL SERVICES

⊕

MARK	DATE	DESCRIPTION
1	03.20.2025	REVISED DRAWING BID DOCUMENTS
	4.28.2025	REVISED DRAWING

PROJECT NUMBER: **47028 - U**  
DESIGNED BY: CJD  
DRAWN BY: RTR  
FIELD CHECK:  
APPROVED:  
SHEET TITLE: **OVERALL FLOOR PLANS**  
DRAWING NUMBER: **U-102**  
SHEET 21 OF 49

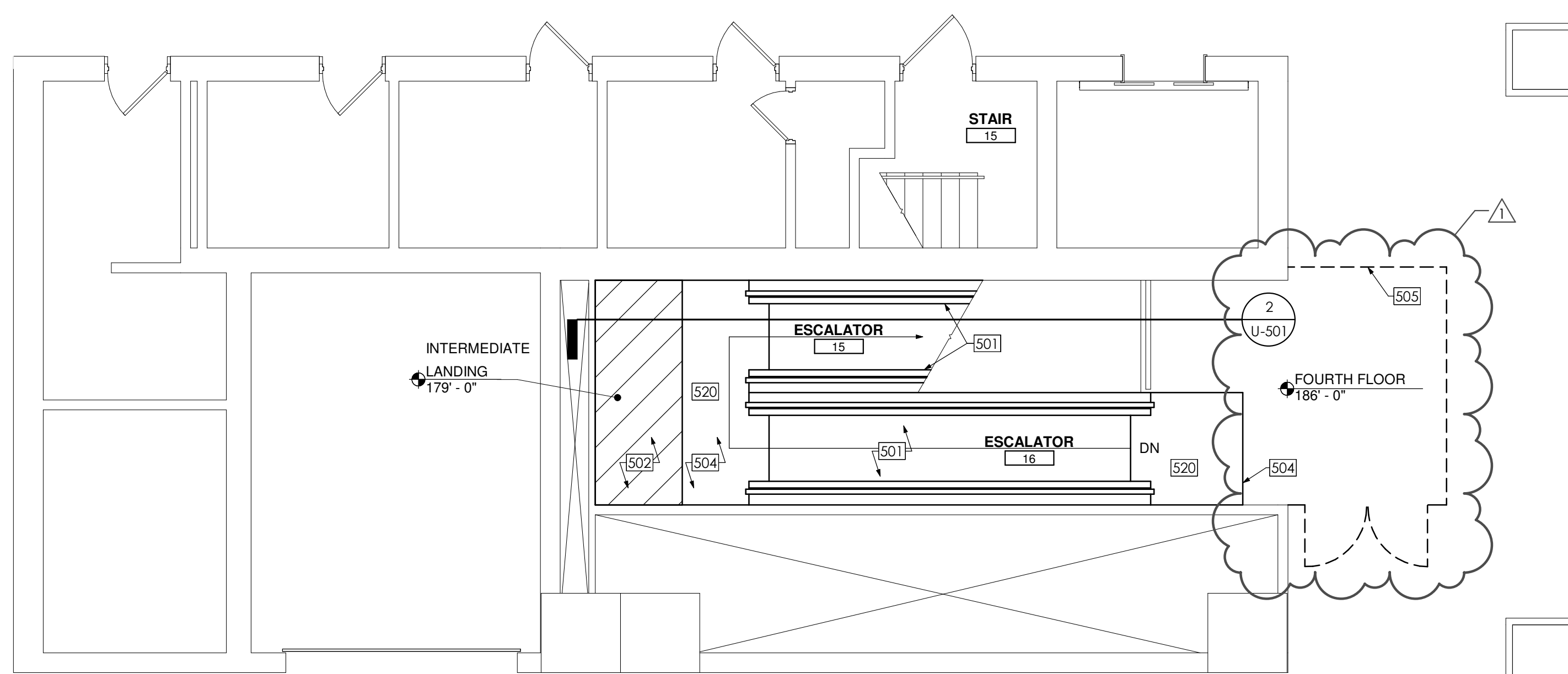
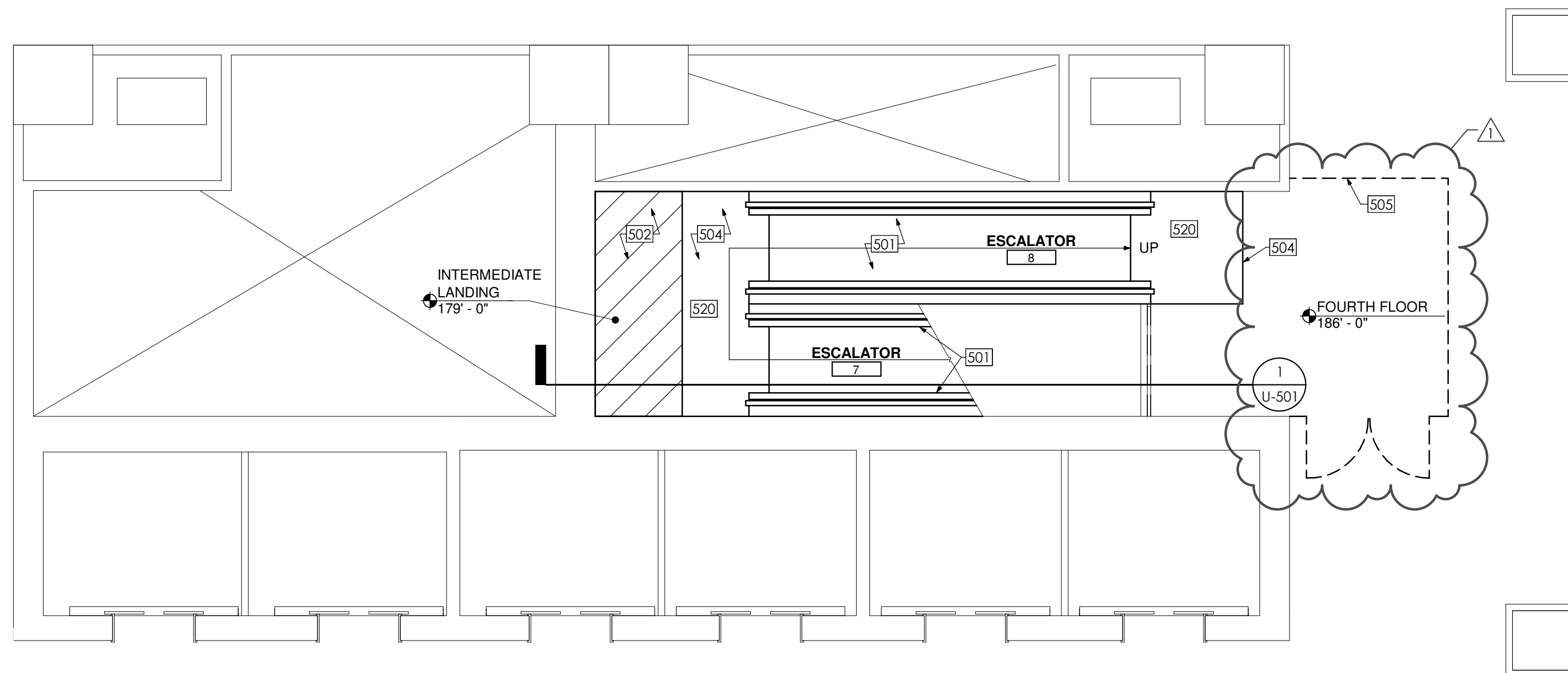

**1 ENLARGED FOURTH FLOOR PLAN**  
3/16" = 1'-0"

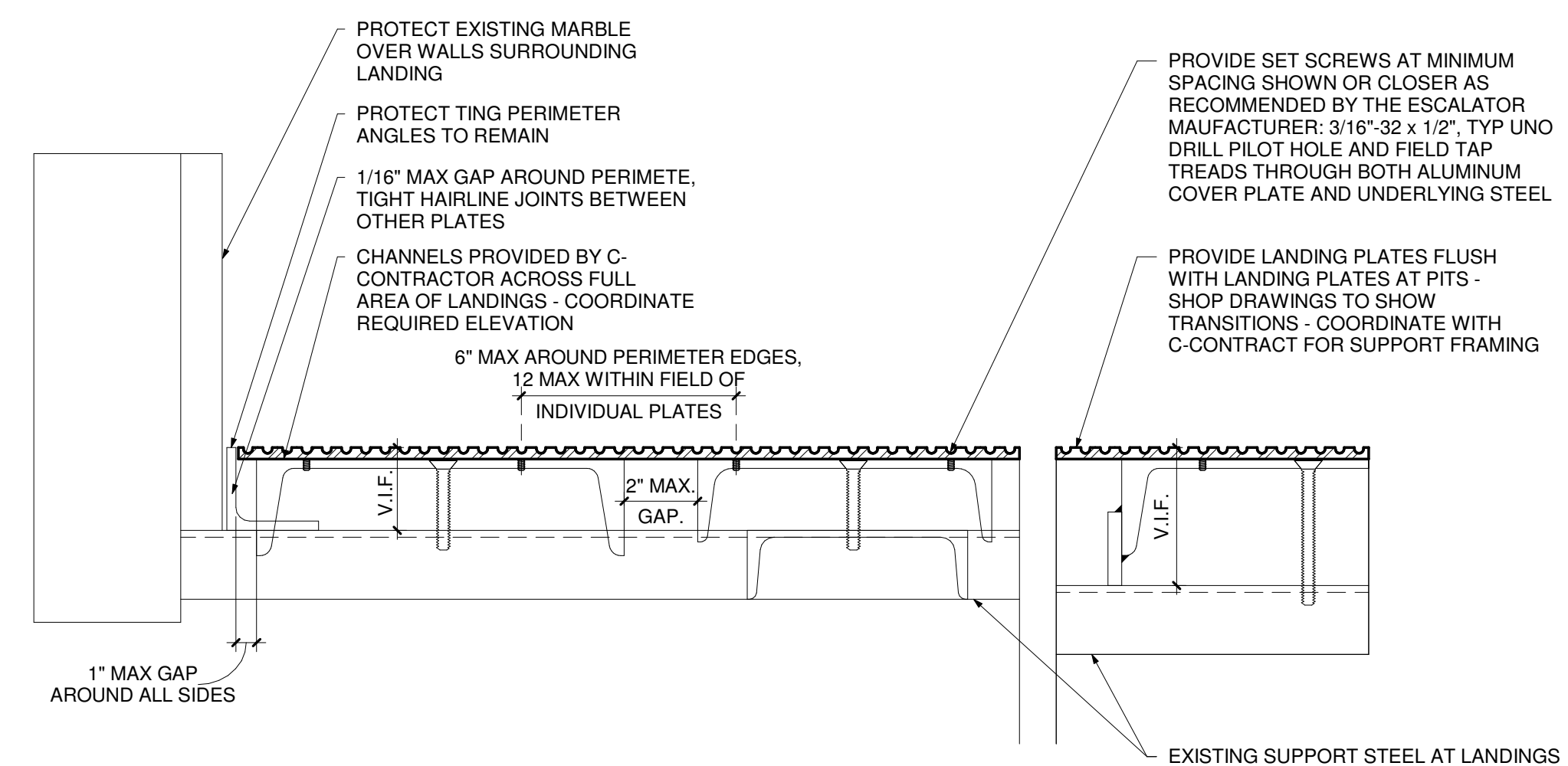

**2 LANDING PLATE DETAIL**  
3" = 1'-0"

**DRAWING NOTES #**

- 501 REMOVE AND PROVIDE ESCALATOR (IN-TRUSS MODERNIZATION) - REFER TO SPECIFICATIONS FOR EXTENT OF ESCALATOR REPLACEMENT - PROTECT THE CEILINGS BELOW ESCALATOR FROM DAMAGE DUE TO FALLING DEBRIS, OIL, LUBRICANT, GREASE, ETC. DURING REMOVAL AND INSTALLATION - COORDINATE WITH OTHER CONTRACTS FOR THEIR SCHEDULED WORK
- 502 REMOVE AND PROVIDE ALL LANDING PLATES - LANDING PLATES TO BE FLUSH WITH EXISTING ADJACENT FLOOR - COORDINATE WITH CONSTRUCTION CONTRACT FOR SUB-FRAMING
- 504 REMOVE AND PROVIDE ALL LANDING PLATES - LANDING PLATES TO BE FLUSH WITH EXISTING ADJACENT FLOOR - REFER TO DETAIL 2/U-405
- 505 TEMPORARY WALL BY C-CONTRACT - COORDINATE WITH C-CONTRACT AND DIRECTOR'S REPRESENTATIVE FOR REQUIRED LAYOUT
- 520 COORDINATE INSTALLATION OF RECEPTACLES AND LIGHTING AT EACH ESCALATOR WELLWAY WITH ELECTRICAL CONTRACT

**DESIGN & CONSTRUCTION**

CONSULTANT  
CERTIFICATE OF AUTHORIZATION #: 1127432



Architectural Resources



**WARNING:**

THE ALTERATION OF THIS MATERIAL IN ANY WAY, UNLESS DONE UNDER THE DIRECTION OF A COMPARABLE PROFESSIONAL, I.E. ARCHITECT FOR AN ARCHITECT, ENGINEER FOR AN ENGINEER OR LANDSCAPE ARCHITECT FOR A LANDSCAPE ARCHITECT, IS A VIOLATION OF THE NEW YORK STATE EDUCATION LAW AND/OR REGULATIONS AND IS A CLASS 'A' MISDEMEANOR.



REGISTRATION EXPIRES:  
12/31/2026

**CONTRACT: ESCALATOR**

**TITLE: REHABILITATE ESCALATORS**

**LOCATION:**  
CULTURAL EDUCATION CENTER  
EMPIRE STATE PLAZA  
ALBANY, NY

**CLIENT:**  
OFFICE OF GENERAL SERVICES

MARK	DATE	DESCRIPTION
1	4.28.2025	REVISED DRAWING
	03.20.2025	BID DOCUMENTS

PROJECT NUMBER: **47028 - U**

DESIGNED BY: CJD

DRAWN BY: RTR

FIELD CHECK:

APPROVED:

SHEET TITLE:  
**ENLARGED PLAN - FOURTH FLOOR**

DRAWING NUMBER:  
**U-405**

SHEET 26 OF 49